

Setting the brewer

Clamping force

It is essential to set the clamping force of the brewer chamber, in order to prevent too much water leaking away via the filter paper. This may be checked by the filter paper. If, after pouring a cup of coffee, the filter paper has become wet for more than one centimeter all round, too much water is leaking away. However, the clamping force may not be set too high, because this will cause excessive wear or the brewer motor to get jammed.

Setting the clamping force

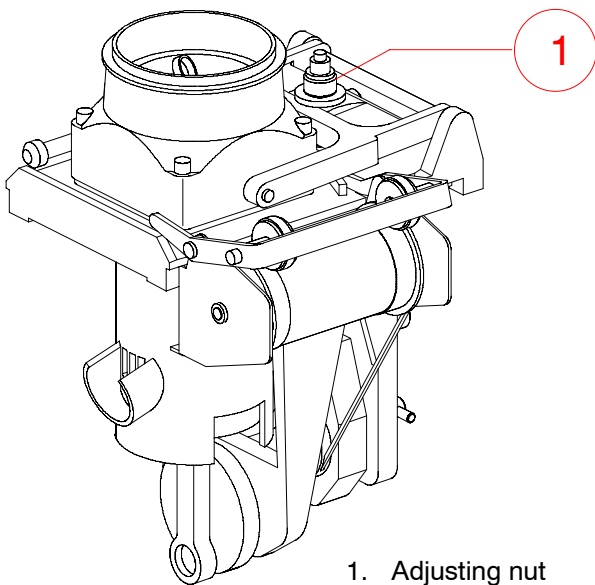

Fig. 1 Setting the brewer chamber

- Place a piece of filter paper between the brewer and the brewer chamber.

- Turn the brewer piston up to its highest position. The brewer chamber has come down completely and will be pressing down on the filter paper.
- Turn the adjusting nut (1.) behind the brewer chamber in such a way that the filter paper may – only just – not be pulled from between the brewer chamber and the brewer.
- Now turn the adjusting nut another turn or half a turn tighter.
- Place the brewer back into the machine.
- Install the filter paper according to the procedure given in the user manual.
- Check the operation by tapping a cup of coffee (use the service spanner to achieve this).
- Turn the adjusting nut a quarter turn **tighter**, if too much water is leaking away via the filter paper.
- Turn the adjusting nut a quarter of a turn **looser** if the piston of the brewer does not move smoothly (during the coming up of the brewer chamber) while it is in its lowest position.

Paper transport

The filter paper transport should be set in such a way that the distance between the cakes of coffee residue is large enough for the next cycle to take place on a piece of filter paper that is completely clean. Too large a distance between the cakes of coffee residue should be prevented as well. This will lead to excessive paper usage, requiring the roll to be replaced more often.

The distance between the cakes of coffee residue should be between **5 and 10 mm**.

Setting the paper transport

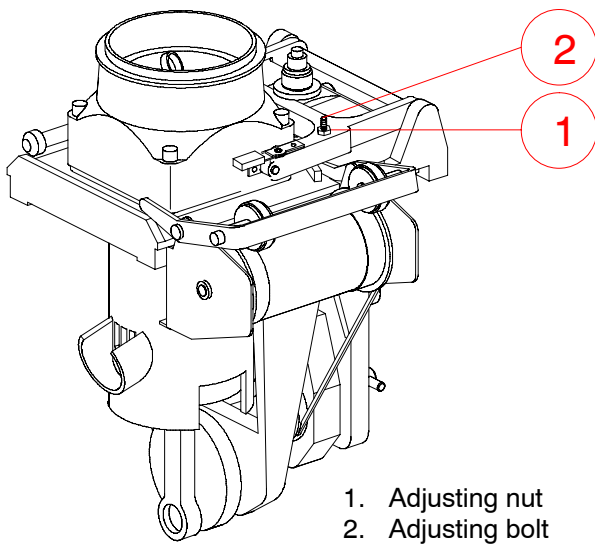

Fig. 2 Setting the paper transport



TIP

- Always check the clamping force of the brewer chamber before changing the settings for the paper transport. Because changing the clamping force of the brewer chamber will affect the paper transport!

WARNING

△ Turn the adjusting nut in closed position, so it can't be tuned too far.

- Unscrew the locking nut (2.), while constraining the adjusting bolt (1.).
- Turn the adjusting bolt upward if there is coffee residue remaining in the brewer chamber. This will **increase the distance** between the cakes of coffee residue.
- Turn the adjusting bolt downward to **decrease the distance** between the cakes of coffee residue.
- Tighten the locking nut after changing the settings.
- Check the functioning of the paper transport.
- Check the distance between the cakes of coffee residue.



TIP

- Turning the adjusting bolt is easiest with the brewer chamber raised to its upper position (when the brewer piston will be in its downmost position).

